

# MTS-T3

1/10 Electric Touring Pro Car Kit  
Instruction Manual

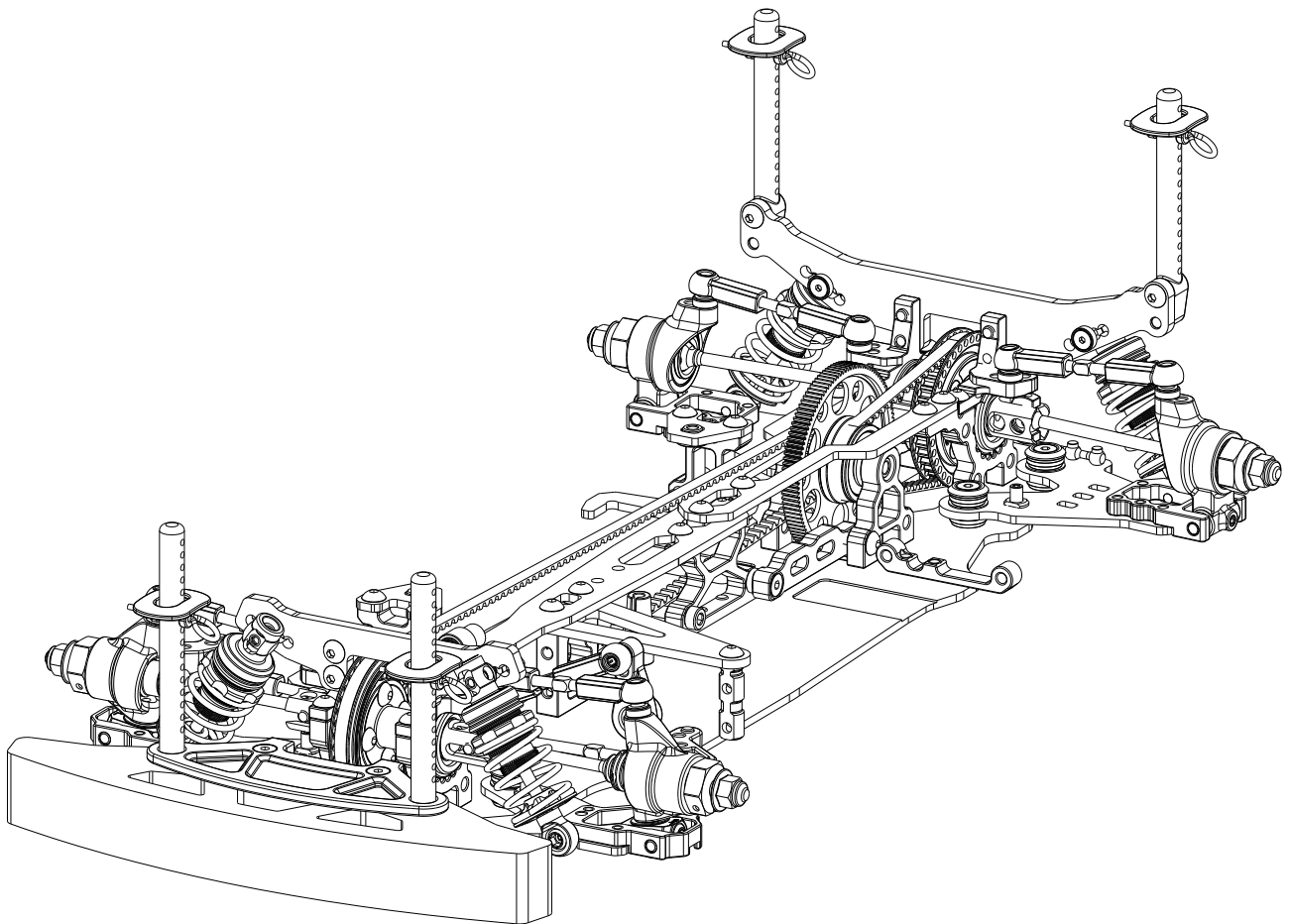

Powered By:







## Introduction:

1:10 Touring Car kit is a professional 1:10<sup>th</sup> 4 wheel drive car and should be built by aged 14 years or over or that they had experience building and operating R/C model cars before. This is not a toy intended for use by beginners or by children without any supervision of a knowledgeable adult. Please read the instruction manual carefully before building.

Race opt should not be liable for any loss, injury or damages, whether direct, indirect, special, incidental, consequential, arising from the use, misuse, abuse of this product or accessories required to operate this product.

## Warnings:

- ⊙ This product is not intended for those ages under 14 year without any adult supervision.
- ⊙ Assemble this kit only in places away from the reach of children.
- ⊙ Exercise car when using tools and sharp instrument and take care some parts that may have sharp edges when building.
- ⊙ Please do not touch any electronic equipment on the model such as motor and speed controller that having higher temperatures after the operation. Otherwise, it may burn yourself seriously by touching them. Better to allow 10~15 minutes to let any electronic equipment cool down.
- ⊙ Please complete a successful pre-run check of your radio equipment and model before the run. Make sure to keep the wheels of the model off the ground when checking the operation of the radio equipment.
- ⊙ When on the model, please always turn on the transmitter before turn on the receiver in the car. When off the model, please always turn off the receiver before turn off the transmitter. Otherwise, the model may become uncontrollable and cause serious damage.
- ⊙ Disconnect the battery pack before storing your model.
- ⊙ Do not get overcharge for the battery or leave battery unattended while charging. Never let children charge the battery without adult supervision.
- ⊙ Do not operate it on public places, roads or areas where its operation can conflict with or disrupt pedestrian or vehicular traffic.
- ⊙ Do not use your model as shown below:

In places where children and people gather	In rain, wind snow or darkness condition
In areas where loud noises can disturb others	At anytime your line of sight to the model may be obstructed or impaired in any way

## Electrical Precautions:

- ⊙ Please do not allow any metal part to short circuit the battery or any electronic part using inside the car kit.
- ⊙ Never put batteries into fire.
- ⊙ Use the recommended charger for the transmitter battery and battery for electronic speed control. Please follow the charging instructions carefully. Please do not over charge the battery or choose the wrong charging mode. It becomes dangerous that causes the explosion and lead to the fire. If battery becomes extremely hot during the charging, please seek the advice from or get replacement from the corresponding battery supplier.
- ⊙ Please unplug charger when not in use.
- ⊙ When not using RC model, please always disconnect and remove the battery.
- ⊙ Low battery may result in loss of control. Please stop running the car at once when you find its speed start to slow down.
- ⊙ After use the battery, the battery remains heat and please recharges it after the battery is cool down.
- ⊙ Never use damaged wires that are dangerous and cause short circuits and may lead to the fire.

## Other Equipment Needed (not included):

Radio transmitter & receiver	Battery for transmitter
Electronic speed control	Steering Servo
540 Type brushes or brushless motor	Pinion Gear (48pitch/64pitch)
190mm body shell	7.4V Nimh or Lipo Battery
Touring Car Tire set	Battery charger

## Tools Needed (not included):

1.5mm, 2.0mm, 2.5mm allen wrench	5.0mm, 5.5mm, 7.0mm hex socket wrench
Modelers craft knife	Turnbuckle wrench
Calipers/Ruler	Camber gauge
Instant glue/Thread lock glue	Shock and Diff Oil
Thrust, Diff and Joint grease	Paint for body shell

Notes: All replacement parts can be found from [www.race-opt.com](http://www.race-opt.com) and can be purchased from local hobby shop. If any further information needed, please email to [enquiry@rc-explorer.com](mailto:enquiry@rc-explorer.com).



# MTS -T3

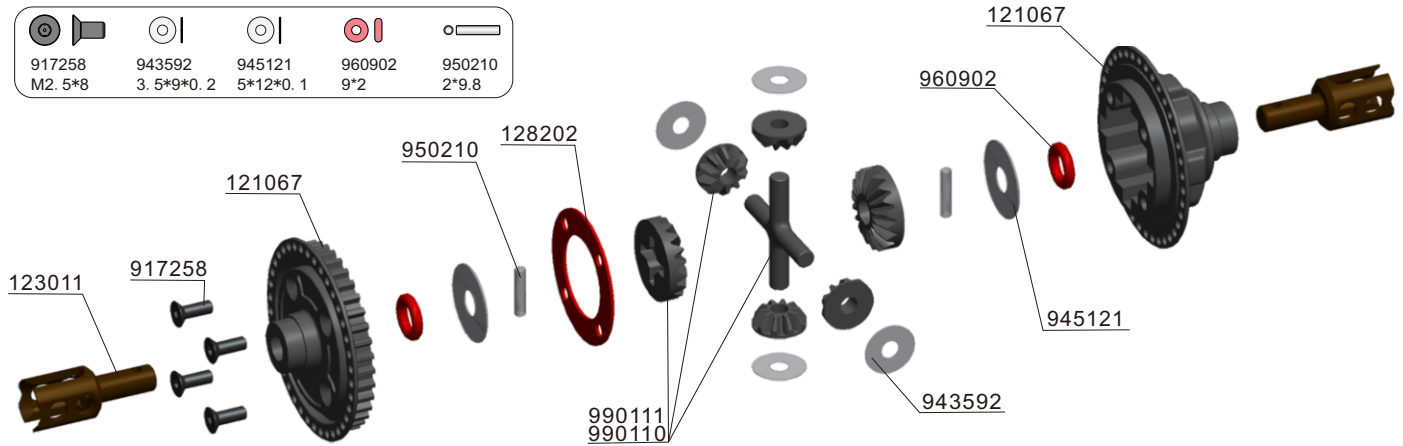

990110 PLANETARY GEAR SET-PLASTIC  
 990111 PLANETARY GEAR SET-HARD COATED  
 123011 UNIVERSAL CVD DRIVE SHAFT-SPRING STEEL 3.6 S2

121067 COMPOSITE GEAR DIFF. CASE & COVER  
 128202 DIFF GASKET 26mm

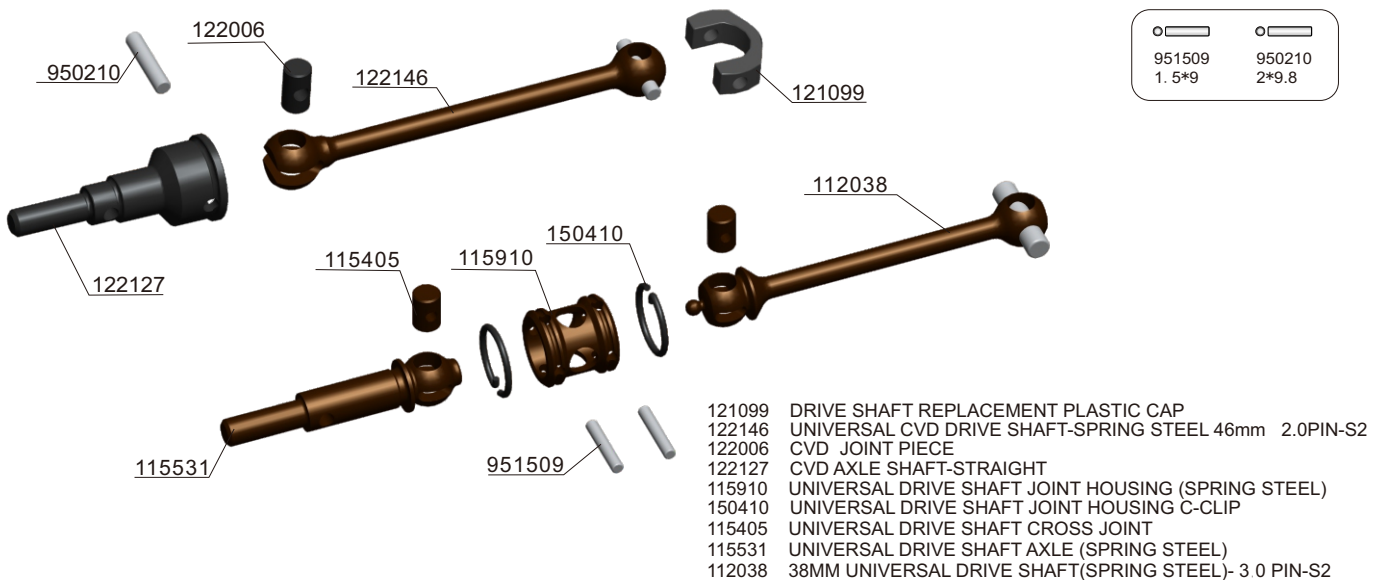
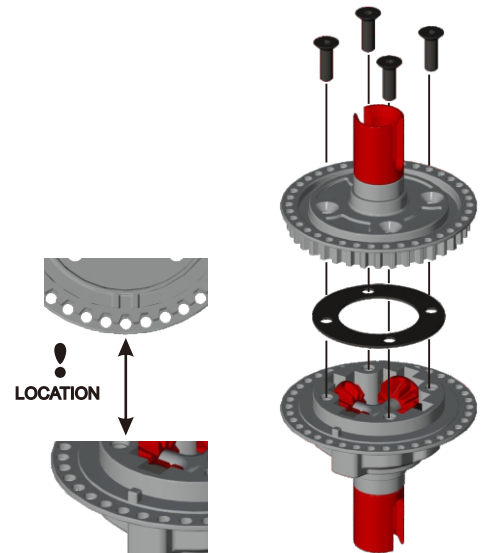
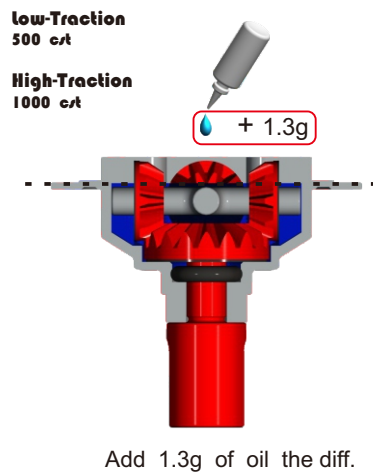
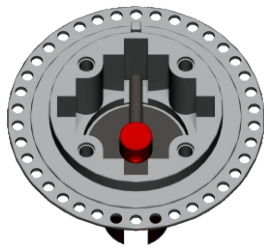

121099 DRIVE SHAFT REPLACEMENT PLASTIC CAP  
 122146 UNIVERSAL CVD DRIVE SHAFT-SPRING STEEL 46mm 2.0PIN-S2  
 122006 CVD JOINT PIECE  
 122127 CVD AXLE SHAFT-STRAIGHT  
 115910 UNIVERSAL DRIVE SHAFT JOINT HOUSING (SPRING STEEL)  
 150410 UNIVERSAL DRIVE SHAFT JOINT HOUSING C-CLIP  
 115405 UNIVERSAL DRIVE SHAFT CROSS JOINT  
 115531 UNIVERSAL DRIVE SHAFT AXLE (SPRING STEEL)  
 112038 38MM UNIVERSAL DRIVE SHAFT (SPRING STEEL)- 3 0 PIN-S2

# MTS -T3

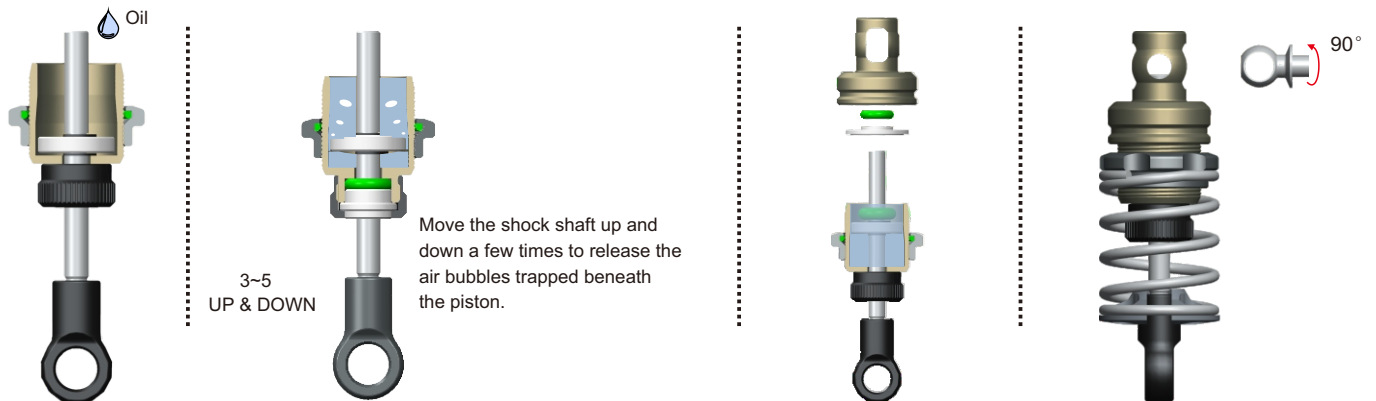
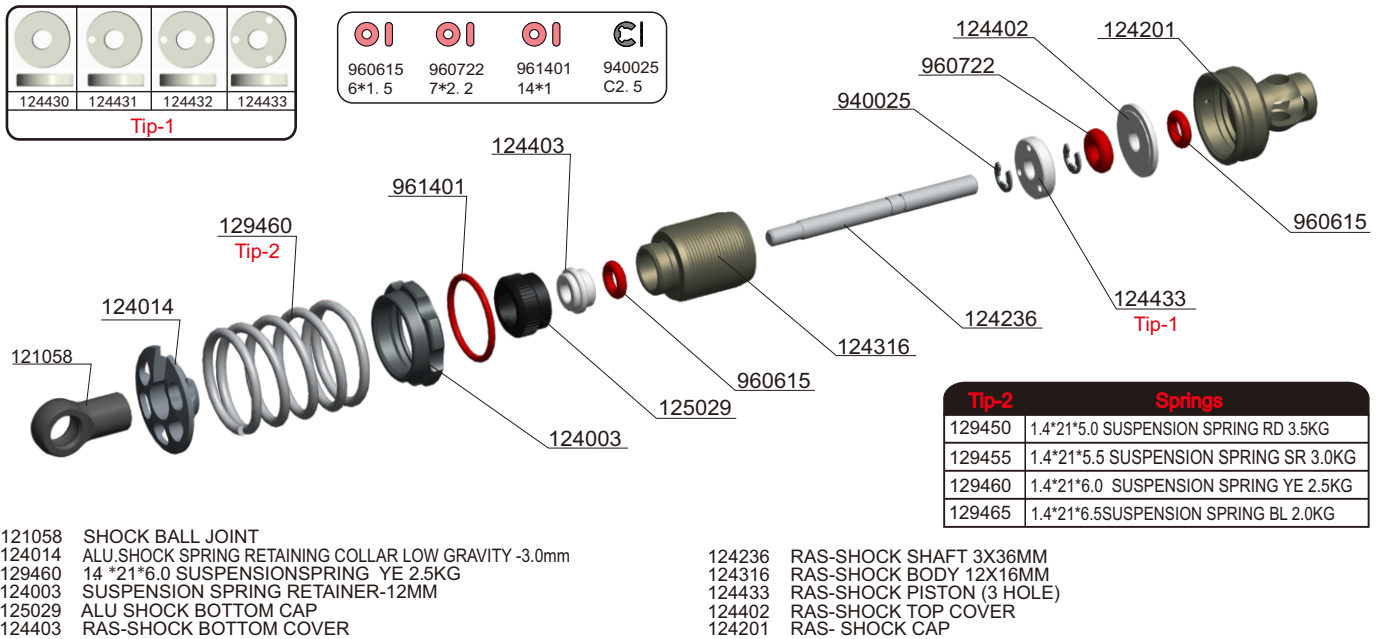
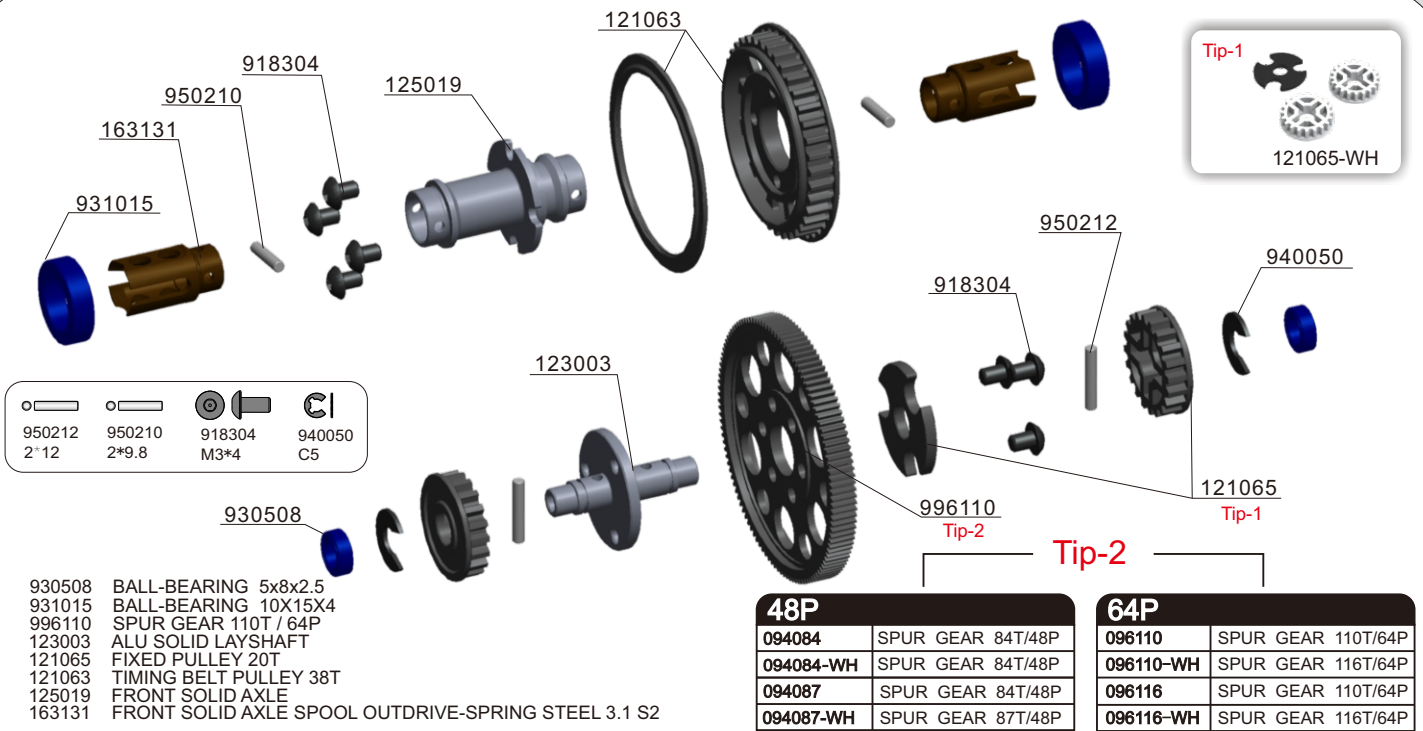

# MTS -T3

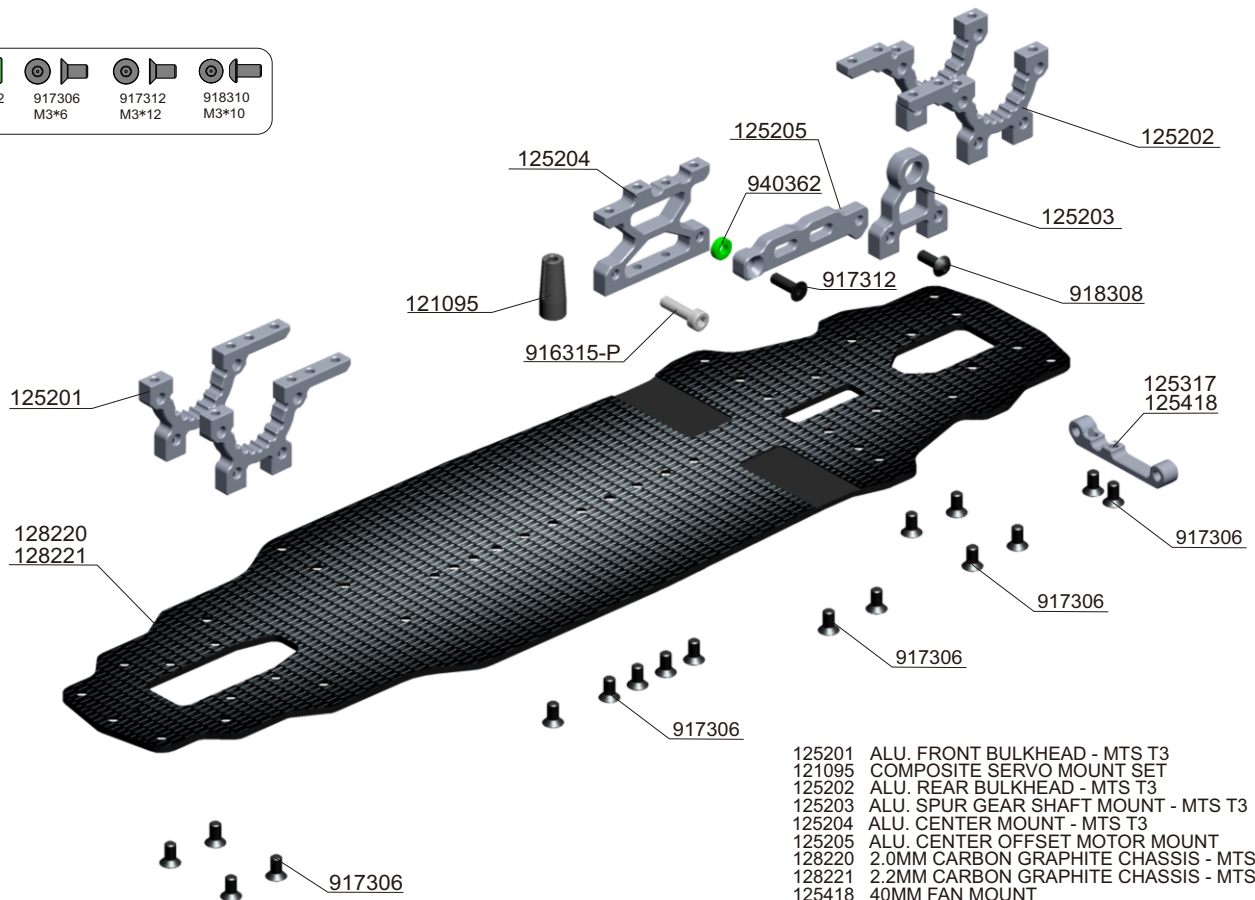
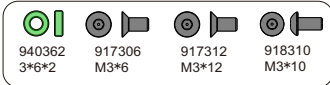

- 125201 ALU. FRONT BULKHEAD - MTS T3
- 121095 COMPOSITE SERVO MOUNT SET
- 125202 ALU. REAR BULKHEAD - MTS T3
- 125203 ALU. SPUR GEAR SHAFT MOUNT - MTS T3
- 125204 ALU. CENTER MOUNT - MTS T3
- 125205 ALU. CENTER OFFSET MOTOR MOUNT
- 128220 2.0MM CARBON GRAPHITE CHASSIS - MTS T3
- 128221 2.2MM CARBON GRAPHITE CHASSIS - MTS T3
- 125418 40MM FAN MOUNT
- 125317 30MM FAN MOUNT
- 916315-P HEX SOCKET CAP SCREW M3X15 PLASTIC

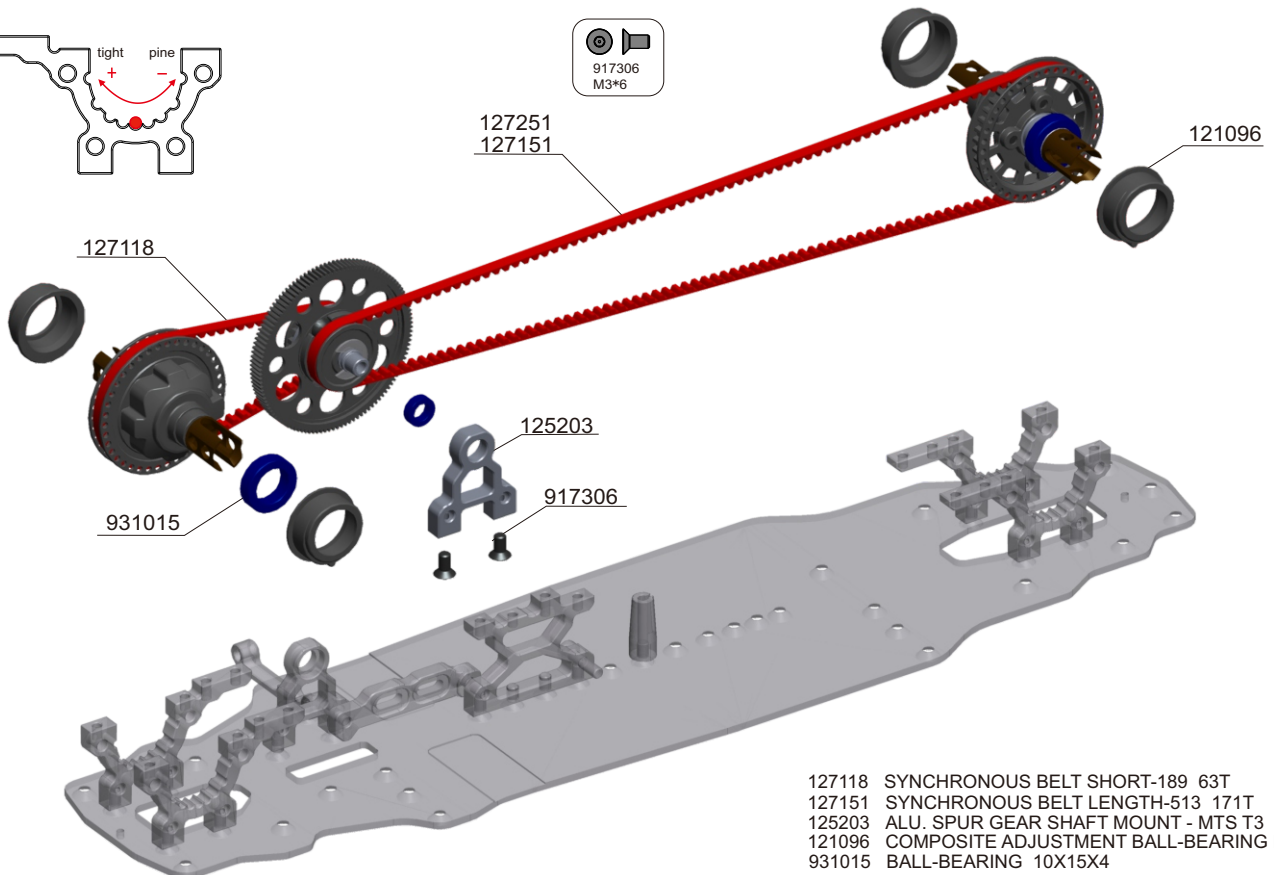
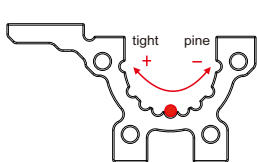

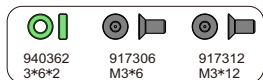

- 127118 SYNCHRONOUS BELT SHORT-189 63T
- 127151 SYNCHRONOUS BELT LENGTH-513 171T
- 125203 ALU. SPUR GEAR SHAFT MOUNT - MTS T3
- 121096 COMPOSITE ADJUSTMENT BALL-BEARING HUB
- 931015 BALL-BEARING 10X15X4

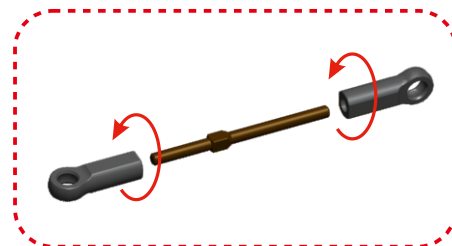

920336 ADJ. TURNBUCKLE L/R36 MM - SPRING STEEL  
924900 PIVOT BALL 4.9\*6MM DOUBLE BEVEL SHOULDERS  
920320 ADJ. TURNBUCKLE L/R 20 MM - SPRING STEEL  
924906 BALL END 4.9MM WITH THREAD 6MM H2.0  
930508 BALL-BEARING 5X8X2.5



		
918306 M3*6	918308 M3*8	940361 3*6*1





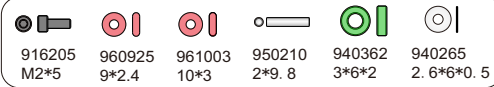
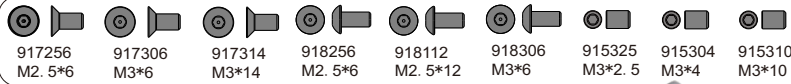

- 920324 ADJ. TURNBUCKLE L/R 24 mm - SPRING STEEL  
 924906 BALL END 4.9mm WITH THREAD 6mm H2.0  
 924908 BALL END 4.9mm WITH THREAD 8mm H2.0  
 930518 BALL-BEARING 5x8x2.5 FLANGED  
 930510 BALL-BEARING 5X10X4  
 930612 BALL-BEARING 6X12X4  
 931015 BALL-BEARING 10X15X4  
 950320 REAR UPRIGHT PIVOT PIN (3\*20)  
 950318 FRONT PIVOT PIN FOR C-HUB 3\*18

**Tip-1**

123114	1.4
123116	1.6
123118	1.8
123120	2.0

- 123116 ANTI ROLL BAR FEMALE SHAFT  
 123016 ANTI ROLL BAR MALE SHAFT  
 121032 COMPOSITE UPRIGHT REAR  
 125012 OPTION ALU WHEEL HUB  
 123704 STEERING BLOCK HOLDER (4DEG)  
 123037 SUSPENSION ARM BUSHING (4.9X6)  
 123052 SUSPENSION ARM TIGHTEN COLLAR (0 2)  
 123035 ARM DROOP SCREW BUSHING  
 123036 SUSPENSION ARM HOLDER WITH BALL END 4.9MM  
 120146 CVD DRIVE SHAFT SPRING STEEL-46mm 2.0PIN -S2  
 121249 COMPOSITE BALL JOINT 4.9MM - CLOSED WITH HOLE  
 121179 COMPOSITE STEERING BLOCK WITH BEARING HOLDER  
 118238 38MM UNIVERSAL DRIVE SHAFT COMPLETE SET (SPRING STEEL)- 3MM PIN

- 121249  
 924906  
 940362  
 120146  
 931015  
 121032  
 950320  
 930612  
 915304  
 125454R  
 125453L  
 128154R  
 128153L  
 918256  
 917256  
 917306  
 940362  
 924908  
 121179  
 930510  
 950210  
 916205  
 125012  
 915304  
 123706  
 123704  
 123702  
 918112  
 940265  
 930518  
 950318  
 128151L  
 128152R  
 917306  
 123036  
 918256  
 123037  
 123035  
 118238  
 924906  
 920324  
 127005  
 127004  
 961003  
 960925  
 123052  
 123054  
 915310  
 128151  
 128152  
 128153  
 128154  
 125451  
 125452  
 125453  
 125454  
 127004  
 127005
- 2.2MM GRAPHITE FRONT ARM (L)  
 2.2MM GRAPHITE FRONT ARM (R)  
 2.2MM GRAPHITE REAR ARM (L)  
 2.2MM GRAPHITE REAR ARM (R)  
 ALU. FRONT ARM JOINT HOLDER (L)  
 ALU. FRONT ARM JOINT HOLDER (R)  
 ALU. REAR ARM JOINT HOLDER (L)  
 ALU. REAR ARM JOINT HOLDER (R)  
 SUSPENSION ARM SILICON O-RING (8X7.5X3)  
 SUSPENSION ARM SILICON O-RING (9X8X3)

**Tip-2**

123014	1.4
123016	1.6
123018	1.8
123020	2.0

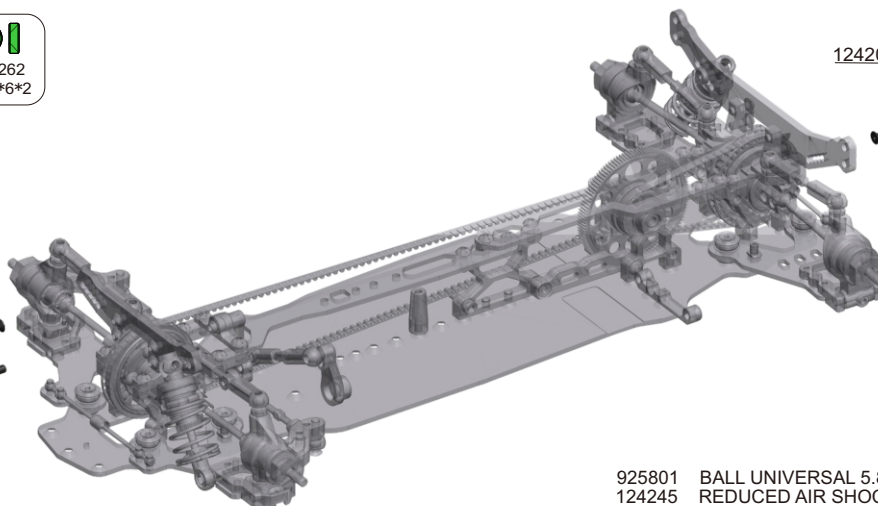
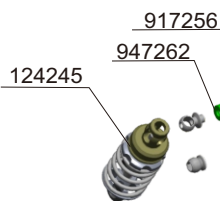
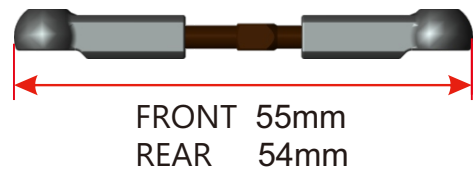

- 925801 BALL UNIVERSAL 5.8 MM HEX H3.0  
 124245 REDUCED AIR SHOCKER (45MM)  
 124204 RAS-SHOCK CAP BALL END 5.9 M2.5mm

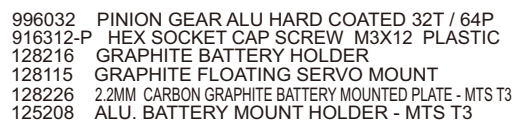

120202	SUSPENSION RUDDER FRAME-STRAIGHT HOLE
120200	OPTIONAL FLOATING SERVO MOUNT
123058	BATTERY PRESSURE FLIM (1MM POM)
123060	FLOATING SERVO SUPPORT STRENGTHENS MESONS 0.8MM
123061	FLOATING SERVO COLUMN 2 HOLE